

# instalação arquitetônica para uma sede do pelotão do corpo de bombeiros militar em campo belo-mg

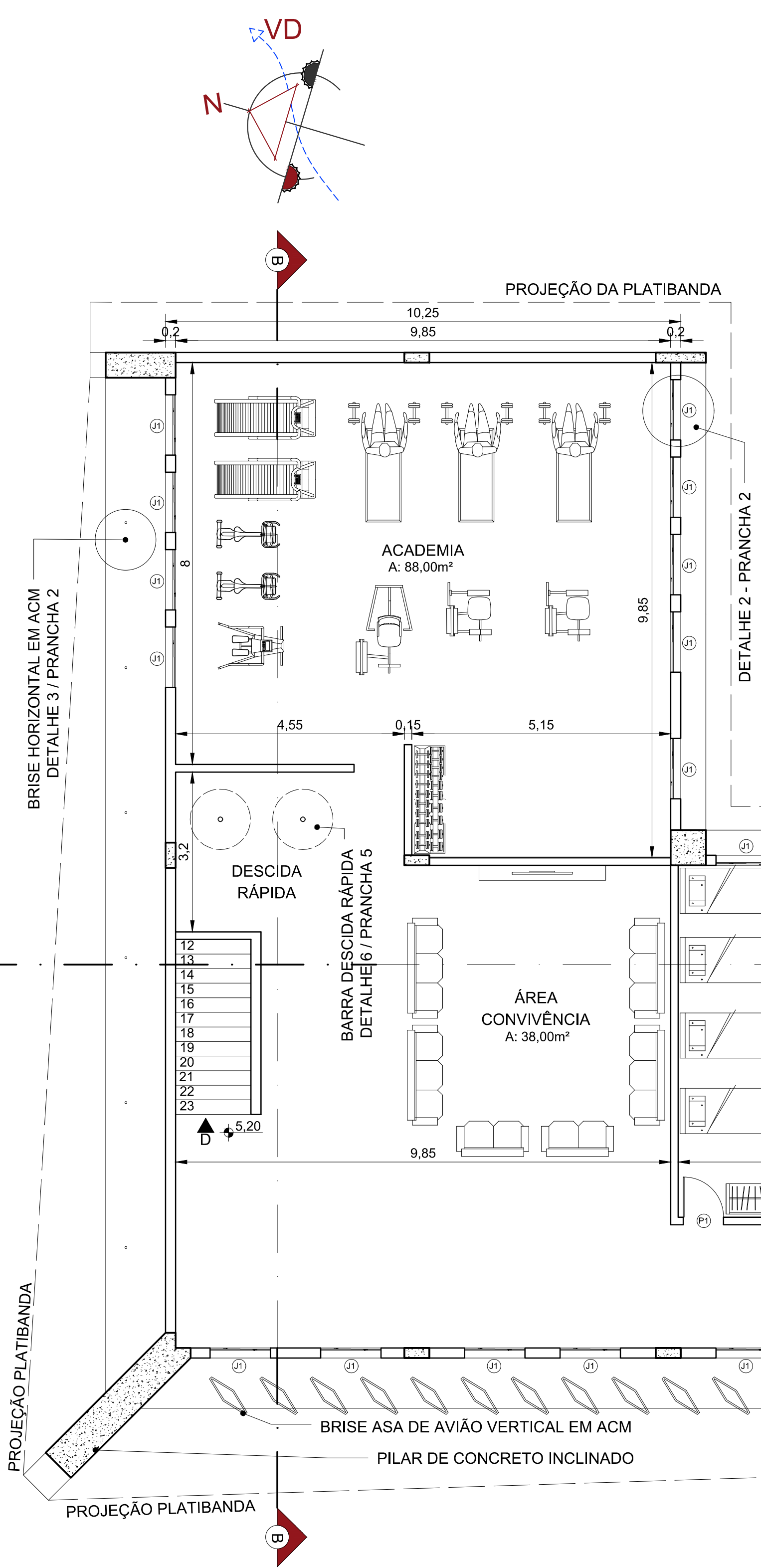

planta 1º pavimento - pelotão | escala 1/75

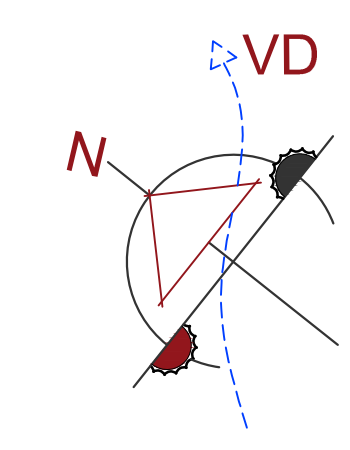
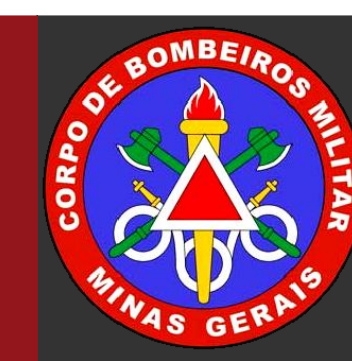
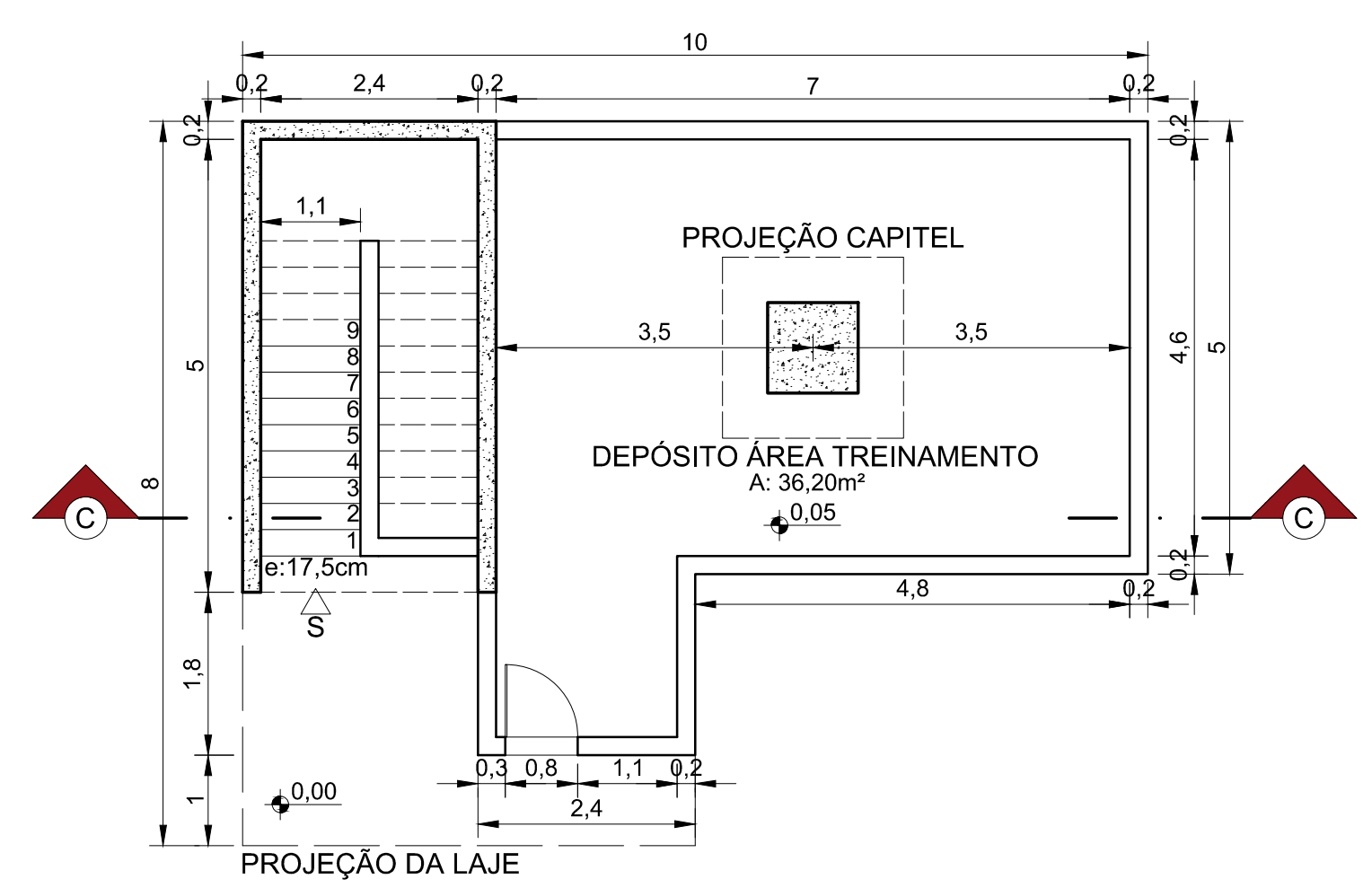

planta térreo - torre treinamento | escala 1/75

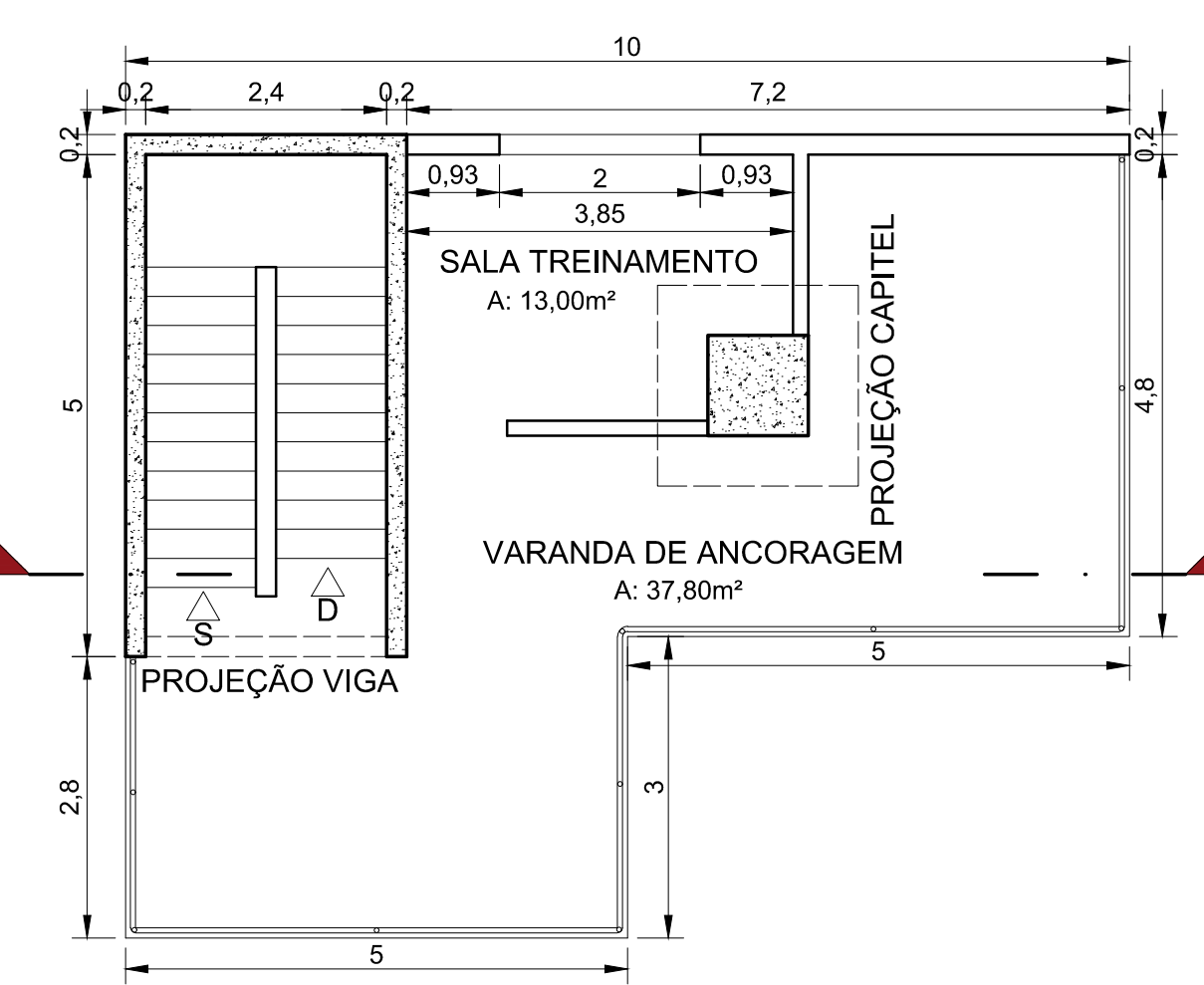

planta tipo 1º ao 4º pvto - torre treinamento | escala 1/75

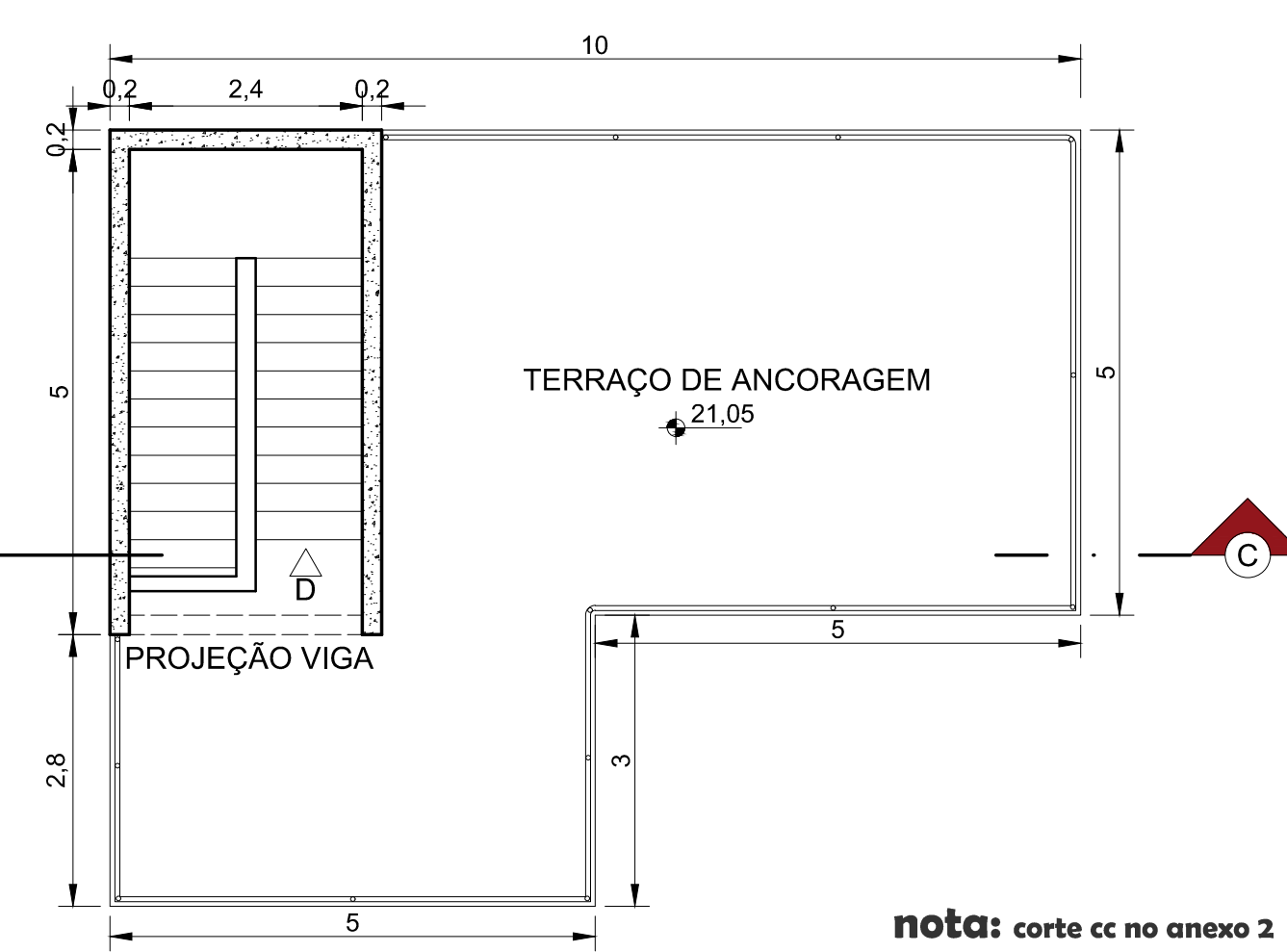

planta terraço - torre treinamento | escala 1/75

nota: corte cc no anexo 2

